



## Screen Lowering Device Type C ElectriCinema

What do you do if you have a very high ceiling, say in a church or town hall? You lower the projection screen into position, then motor down the screen.

Using a secondary motor system that lowers and raises an ElectriCinema projection screen into position, the device comes with a top enclosure for the screen to rest in when not in use and full cable management for the primary screen and secondary lift motor.

### Market Segments:



Home Entertainment



Education



Government



Corporate

### Benefits include:

- Benefits include
- Lowers the screen into position
- Screen enclosure
- Back-up fall arrestor for additional safety
- System includes screen



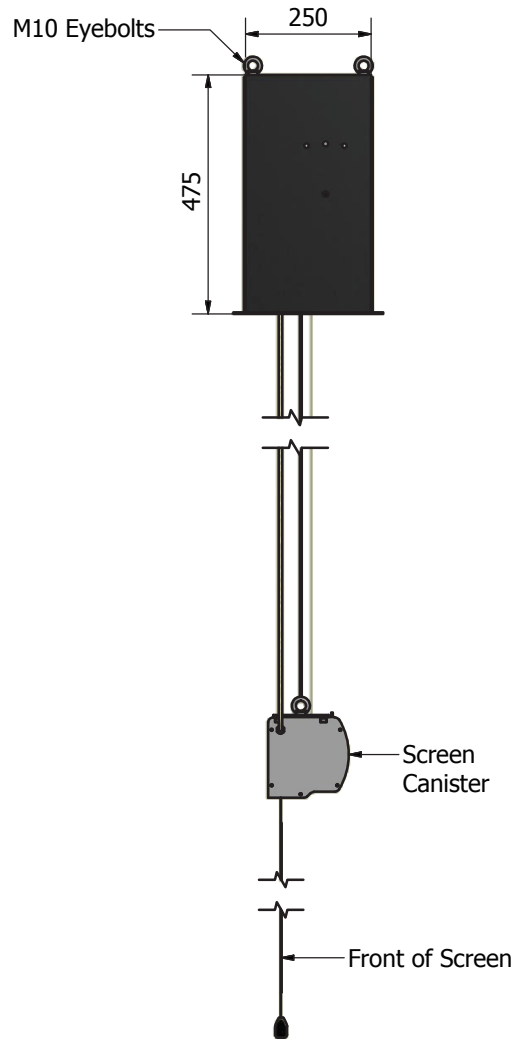

Coreflute covers on sides and top.

Cable Management for Power

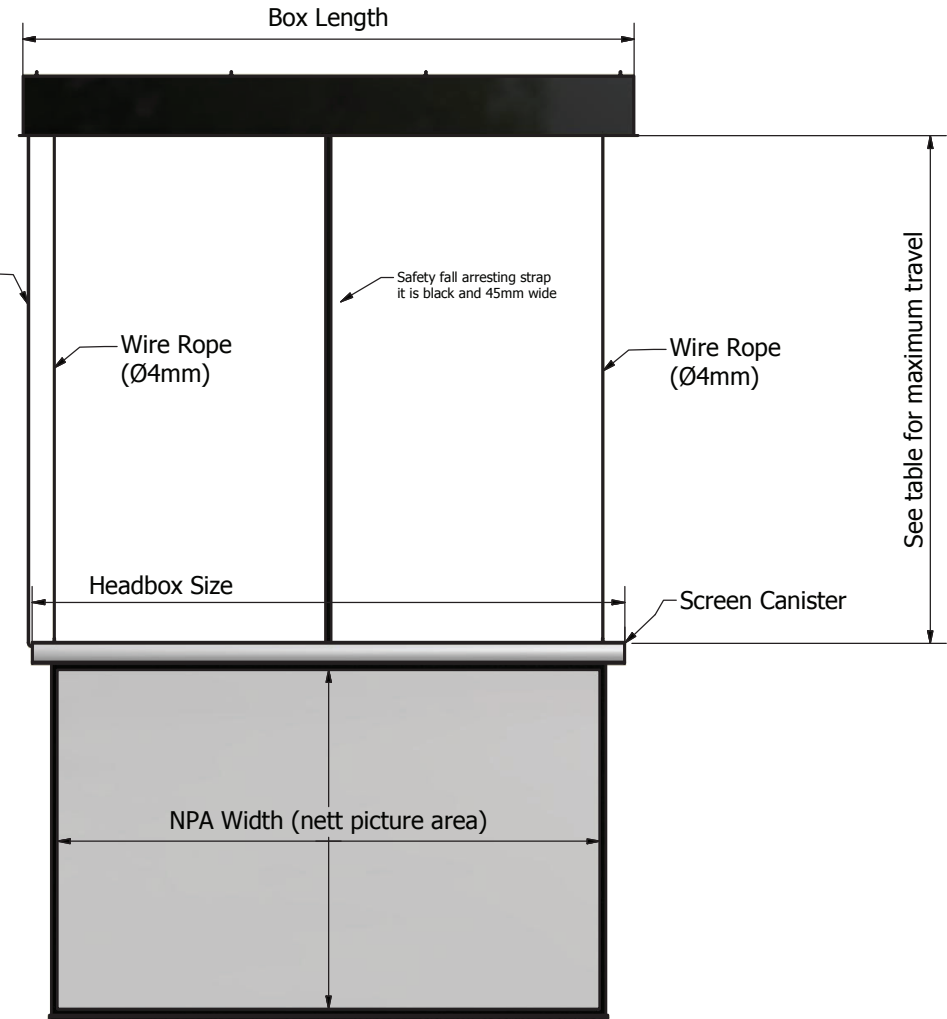

**NOTES:**

- Designed for in ceiling installation
- Please seek advice if exposed installation is required.

Manufacturing tolerance +/- 10mm on in ceiling box, screen headbox, and slatrod  
All dimensions are in (mm) If installed in ceiling always allow for removal for servicing.

The Concept, Design and Details in this drawing are the property of Screen Technics with whom the copyright resides. They may not be reproduced without written permission of Screen Technics.

Date  
16/07/2019

Part Number  
SLD6xxxxx-C

Rev  
02

**Product Features**

**DESCRIPTION:**

Lifting Device to lower motorised screen into position with high ceiling

**BOX:**

MDF Construction with Ceiling Edge Strip and Cable Management System

**SCREEN:**

Pricing includes the cost of the Motorised Screen (ElectriCinema)

**SURFACE:**

Unity White PVC (no black backing)- Gain 1.0, Refer to screen material options for additional surface options

**TRAVEL:**

Standard travel equals picture area width (extra travel available on some models to a maximum of 4200mm)

**SIZES:**

160" to 220" Diagonal custom sizes & formats available upon request

**BRACKETS:**

8 off M10 eyebolts

**OPTIONS:**

Extra Travel and various control options

**ARCHITECTS SPECIFICATION**

The screen lowering device shall be an Australian made Screen Technics Type C model \_\_\_\_\_ Including ElectriCinema projection screen with Matt White surface and shall be located where indicated on the plans.

Installation shall be done in accordance with the manufacturer's instructions

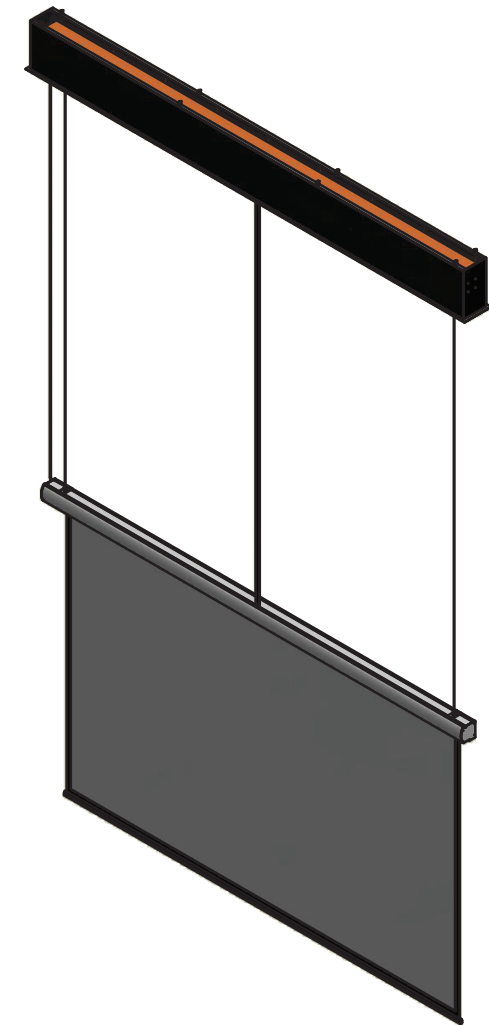

ITEM NO	INCH DIAGONAL	IMAGE SIZE mm	FORMAT	MAX CASE TRAVEL	BOX LENGTH mm	BOX WIDTH mm	BOX HEIGHT mm	WEIGHT kg
SLD616019-C	160"	2440 x 3250	Video 4:3	3300	3800	250	475	190
SLD617019-C	170"	2590 x 3455	Video 4:3	3500	4005	250	475	195
SLD618019-C	180"	2745 x 3660	Video 4:3	3700	4210	250	475	205
SLD619019-C	190"	2895 x 3860	Video 4:3	3900	4410	250	475	210
SLD620019-C	200"	3050 x 4065	Video 4:3	4100	4615	250	475	220
SLD621019-C	210"	3200 x 4265	Video 4:3	4200	4815	250	475	230
SLD622019-C	220"	3355 x 4470	Video 4:3	4200	5020	250	475	240
SLD623019-C	230"	3505 x 4675	Video 4:3	4200	5425	250	475	255
SLD616029-C	160"	1995 x 3545	HDTV 16:9	3600	4095	250	475	200
SLD617029-C	170"	2115 x 3765	HDTV 16:9	3800	4315	250	475	205
SLD618029-C	180"	2240 x 3985	HDTV 16:9	4000	4535	250	475	215
SLD619029-C	190"	2365 x 4205	HDTV 16:9	4200	4755	250	475	225
SLD620029-C	200"	2490 x 4425	HDTV 16:9	4200	4975	250	475	235
SLD621029-C	210"	2615 x 4650	HDTV 16:9	4200	5200	250	475	245
SLD622029-C	220"	2740 x 4870	HDTV 16:9	4200	5420	250	475	255
SLD616069-C	160"	2155 x 3450	16:10	3500	4000	250	475	195
SLD617069-C	170"	2290 x 3665	16:10	3700	4215	250	475	200
SLD618069-C	180"	2425 x 3880	16:10	3900	4430	250	475	210
SLD619069-C	190"	2560 x 4095	16:10	4100	4645	250	475	220
SLD620069-C	200"	2695 x 4310	16:10	4200	4860	250	475	230
SLD621069-C	210"	2830 x 4525	16:10	4200	5075	250	475	240
SLD622069-C	220"	2965 x 4740	16:10	4200	5290	250	475	250

Manufacturing tolerance +/- 10mm on in ceiling box, screen headbox, and slatrod  
All dimensions are in (mm) If installed in ceiling always allow for removal for servicing.

The Concept, Design and Details in this drawing are the property of Screen Technics with whom the copyright resides. They may not be reproduced without written permission of Screen Technics.

Date	Part Number	Rev
16/07/2019	SLD6xxxxx-C	02

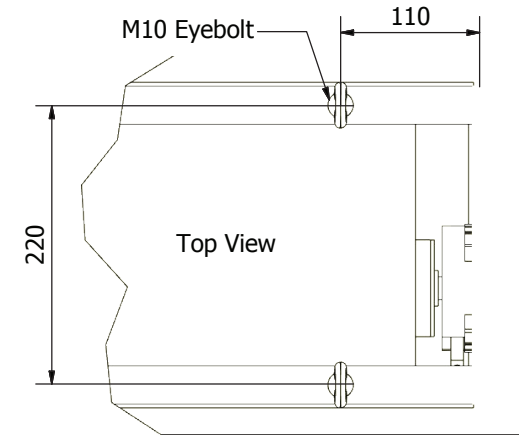
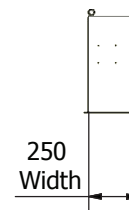
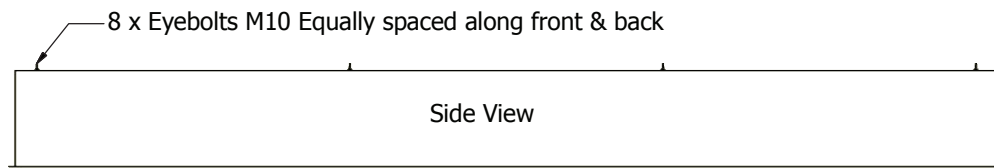
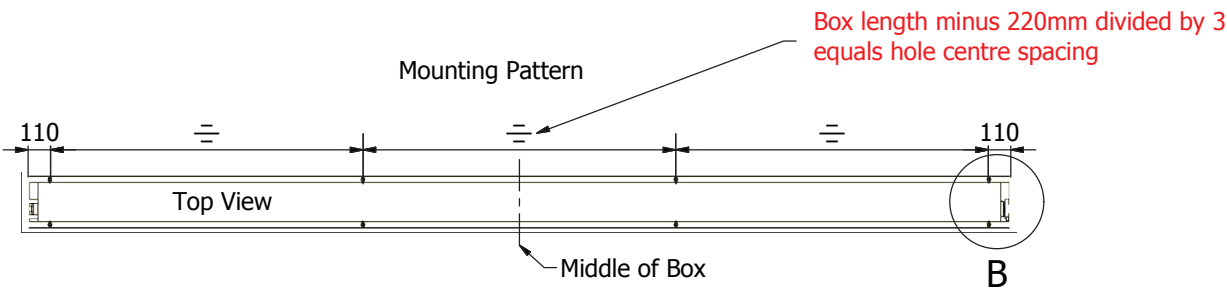
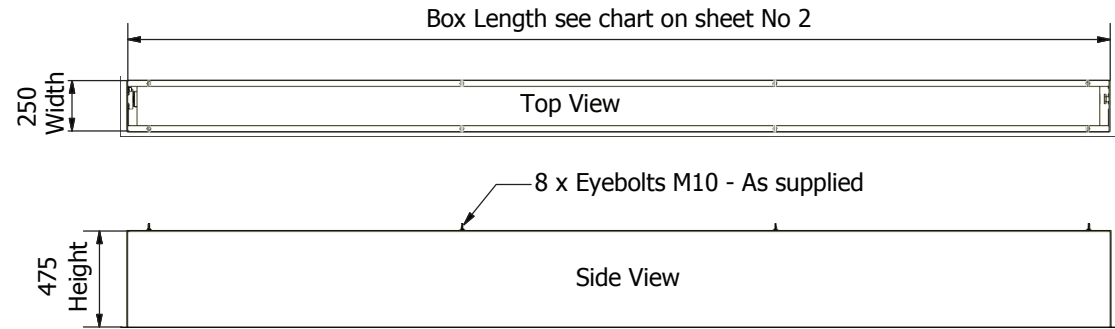
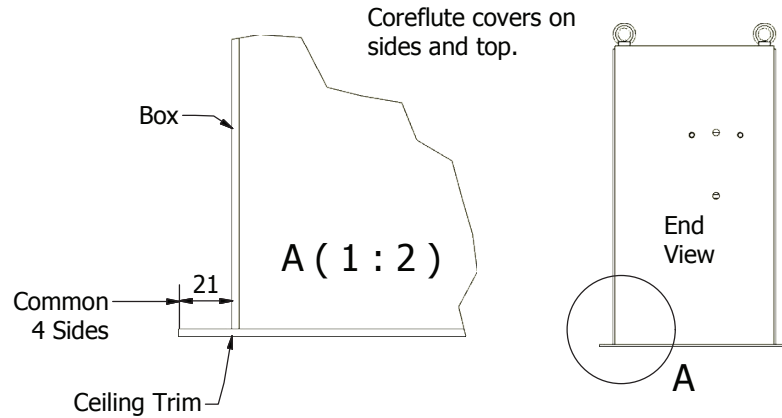

**B (1 : 4)**

**NOTES:**

- Designed for in ceiling installation
- Please seek advice if exposed installation is required.

Manufacturing tolerance +/- 10mm on in ceiling box, screen headbox, and slatrod  
 All dimensions are in (mm) If installed in ceiling always allow for removal for servicing.

AUSTRALIA

22-24 Suttor Road  
 Moss Vale NSW 2577  
 +61 2 4869 2100

NEW ZEALAND

44 Mahana Road  
 Te Rapa, Hamilton  
 +0800 022 821